



All the patents are held accountable counterfeiting.

## Features



## Green Power

- Adjustable output voltage and LED display on the panel
- Standard/Din Rail Mounting Dual Purpose, meet EU EN 43880 installation dimension standard 2SU
- No-load Consumption is lower than 0.3W
- Comply with High Efficiency Power 80Plus Criterion
- Comply with 2010. Energy Conservation Power Erp Regulation
- Convection cooled high reliability
- 2 years warranty
- Output modify range: 3V~200VDC

DIMENSIONS:52.5(H)\*90.7(D)\*35(W)mm

WEIGHTS: 117g

## General specifications

## INPUT

Input range  
Input frequency  
Max. I/P current / Inrush current (25°C)

90~264VAC  
127~380VDC  
47~63Hz  
1.01A/40A@110VAC  
0.69A/80A@220VAC

No Frame Ground Design

## OUTPUT

Hold-up time 13ms  
Short protection Autorecovery  
Over load protection Automatic power limited

## Detail specifications

## 30~50 Watts

MODEL	O/P Volt Adj. ± %	Load(Current) <sup>1</sup>			Ripple & Noise <sup>4</sup>	Line REG. <sup>2</sup>	Load REG. <sup>3</sup>	Efficiency <sup>5</sup>	O.V.P
		Min.	Rated	Max.					
DLP1030D-05S	V : +5V ±10%	0A	6.0A	8.0A (3S)	50mV	±1%	±1%	78% Ref.	7.13 ~ 7.88V
DLP1050D-12S	V : +12V ±10%	0A	4.2A	4.2A	120mV	±1%	±1%	85% Ref.	17.1 ~ 18.9V
DLP1050D-24S	V : +24V ±10%	0A	2.1A	2.1A	240mV	±1%	±1%	86% Ref.	31.4 ~ 34.7V
DLP1050D-48S	V : +48V ±10%	0A	1.04A	1.04A	480mV	±1%	±1%	86% Ref.	64.6 ~ 71.4V

## CE Standards

EN 55032, EN 55035,  
EN 61000-3-2, EN 61000-3-3,  
(EN 61000-4-2, EN 61000-4-3,  
EN 61000-4-4, EN 61000-4-5,  
EN 61000-4-6, EN 61000-4-8,  
EN 61000-4-11)  
LVD: EN 62368-1

## Safety Standards



UL 508 Meet



CE Marking



Double Insulated

## Environments

Operating Temperature -15 ~ 50°C, Ambient  
Operating Humidity 20 ~ 90% RH, No Condensing  
Storage Temperature -20 ~ 85°C, Ambient  
Vibration 2G, 10~500Hz, 3 axes

## NOTE

1. Each output can provide up to maximum load, but total load can not exceed rated output power.
2. Line regulation is measured from low line to high line at rated load.
3. Load regulation is measured from 20% to 100% of rated load at 220VAC input.
4. Ripple & Noise are measured with 20MHz oscilloscope at 220VAC by using a 20cm long 12" twisted pair-wire with a 0.1uF/630V metal capacitor & a 47uF electrolytic capacitor parallel on the test point.
5. Efficiency is measured at rated load and 220VAC input.
6. Hold-up time is measured at rated load and 220VAC input.
7. Output Voltage Adjustable is measured on 5% of rated load.
8. Reign Power reserve the right to change specifications at any time without notice.



All the patents are held accountable counterfeiting.

Mechanical Details

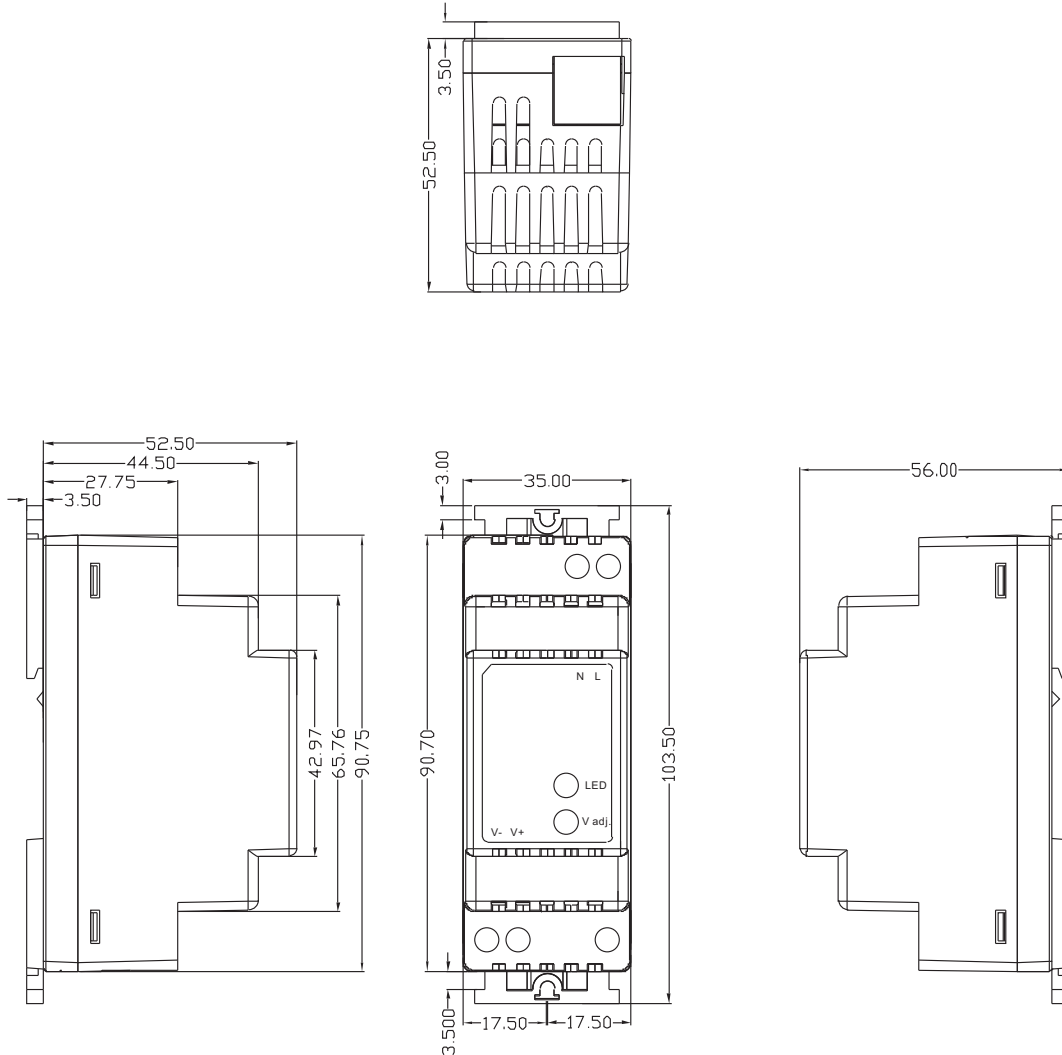

Panel Designation

CASE NO. : CS025D  
UNIT : mm  
DIMENSION : 52.5(H)\*90.7(D)\*35(W)  
MATERIAL : PLASTIC  
COLOR : BLACK

Symbol	Description
N	Neutral Terminal Of AC Input (No Polarity At DC Input)
L	Line Terminal Of AC Input (No Polarity At DC Input)
V-	DC Negative Output Terminal
V+	DC Positive Output Terminal
LED	Green LED Indicator
V adj.	Potentiometer For Output Voltage